

# DATA SHEET/Datablad:

Phoenix Twin Hopper 10 – 100 kW, side hanging  
Phoenix twin-silo 10 – 100 kW, sidehængt

SKU: 902610

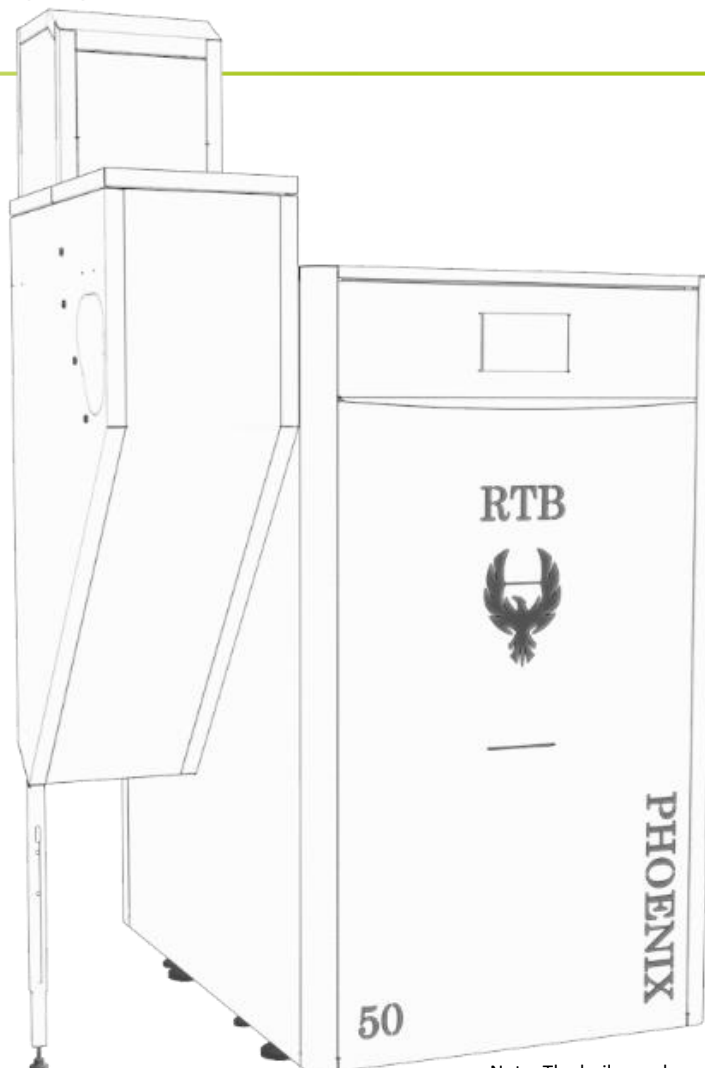

Note: The boiler and vacuum system  
is not included

# DATA SHEET/Datablad:

Phoenix Twin Hopper 10 – 100 kW, side hanging

Phoenix twin-silo 10 – 100 kW, sidehængt

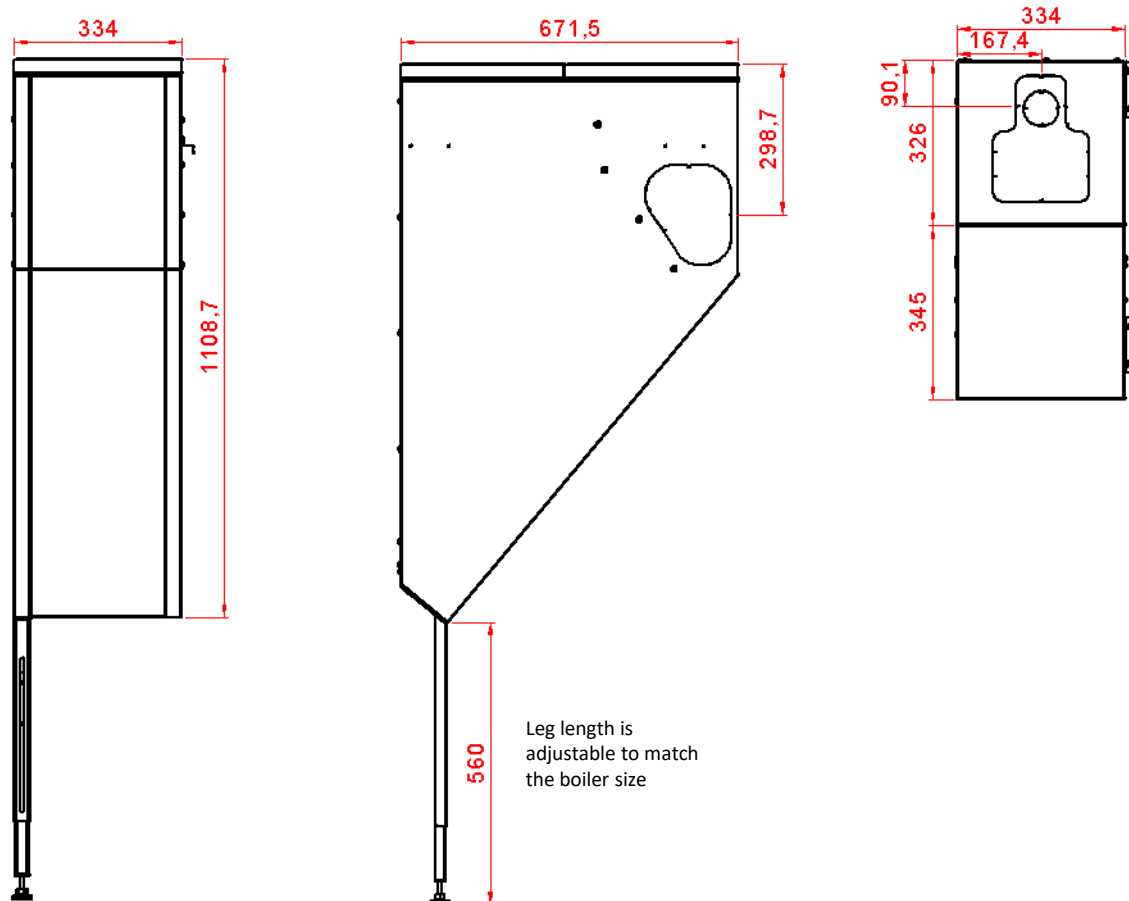

Name	Phoenix Twin Hopper 10 – 100 kW, Side hanging	
SKU:	Varenr:	902610
Weight:	Vægt:	<b>37 kgs</b>
Length:	Længde:	671,5 mm
Width:	Bredde:	334 mm
Compatible with	Passe med:	Phoenix 10, 16, 30, 50, 80, & 100